

Double hose tail steel galvanised 150 mm hose tail (0200941)



TECHNICAL SPECIFICATIONS

Material steel

Surface treatment galvanised

Connection hose tail

Size 150 mm

DIMENSIONS

L 300 mm

ØDo-1 150 mm

ØDo-2 150 mm

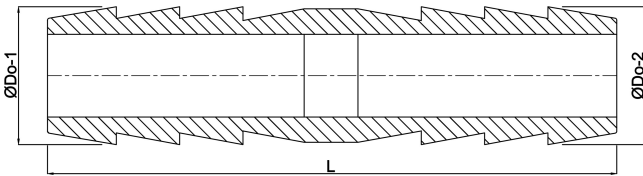

Last modified date: 13/03/2026

Bosta UK Ltd.
Reflection House
Olding Road
Bury St. Edmunds
Suffolk
IP33 3TA
T +44 (0) 1284 716580

[E enquiries@bosta.co.uk](mailto:enquiries@bosta.co.uk)

<http://www.bosta.com>