

**Hayward Pool pump PP GF 63  
mm glue socket 8,2/4,7A  
400VAC black type RS II 30303  
3HP (7017120)**



**HAYWARD®**

# TECHNICAL SPECIFICATIONS

Colour	black
Pump body	PP GF
Material impeller 1	noryl
Material seal	stainless steel 304
Connection	glue socket
Max. temperature	35 °C
Width	234 mm
Height	305 mm
Frequency	50 Hz
IP value	IP55
Type	RS II 30303
Capacity	32,85 m <sup>3</sup> /h
Output Power	3 HP
Size	63 mm
Length	630 mm
Voltage	400VAC
Weight	20.5 kg

Power 2.2 kW

Ampere 8,2/4,7 A

BEP Capacity 21.125

BEP Head 17.3

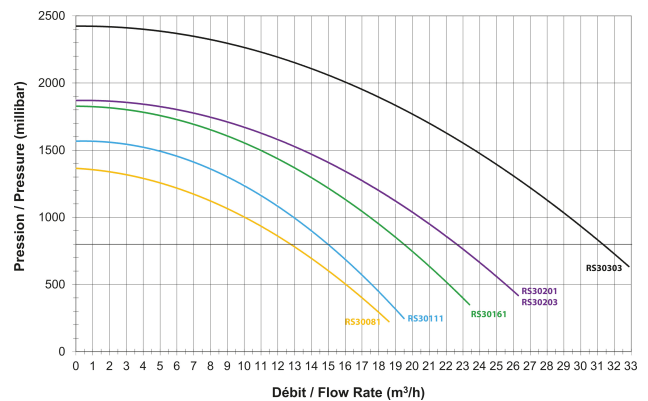
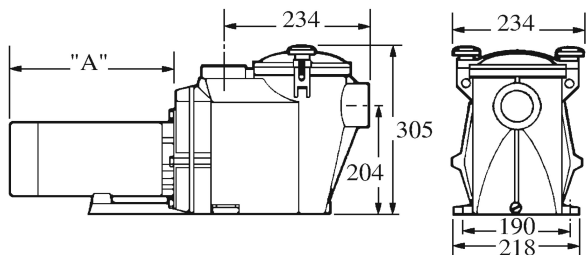

## PRODUCT INFORMATION

Quiet, yet heavy-duty, the Hayward RS II pool pump delivers optimum filtration control and less need for cleaning thanks to the spacious filter-basket. The highly-efficient, German motor ensures smooth running and a reliable lifetime.

Features:

- Union connection: Glue socket 63 mm
- Salt water resistant to 0.4% (4gr/ltr)
- Exclusive by Bevo/Bosta
- 180 degrees rotatable box for convenient access
- Suitable for pools up to 100m<sup>3</sup>

**Last modified date: 25/05/2026**

Bosta UK Ltd.  
Reflection House  
Olding Road  
Bury St. Edmunds  
Suffolk  
IP33 3TA  
T +44 (0) 1284 716580  
E [enquiries@bosta.co.uk](mailto:enquiries@bosta.co.uk)  
<http://www.bosta.com>