

VDL Ball valve PVC-U 16 mm glue socket 16bar grey type DIL (0100842)



VDL Van de Lande

TECHNICAL SPECIFICATIONS

Colour grey

Type DIL

Material PVC-U

Operation lever

Colour lever orange

Handle material PVC-U

Housing construction 3-part

Material seal EPDM

Connection glue socket

Temperature range 0°C - 60°C

Size 16 mm

Pressure 16 bar

DIMENSIONS

Ct-1 56 mm

Lb 84 mm

R 82 mm

ØDf 15 mm

ØDi-1 16 mm

ØDi-2 16 mm

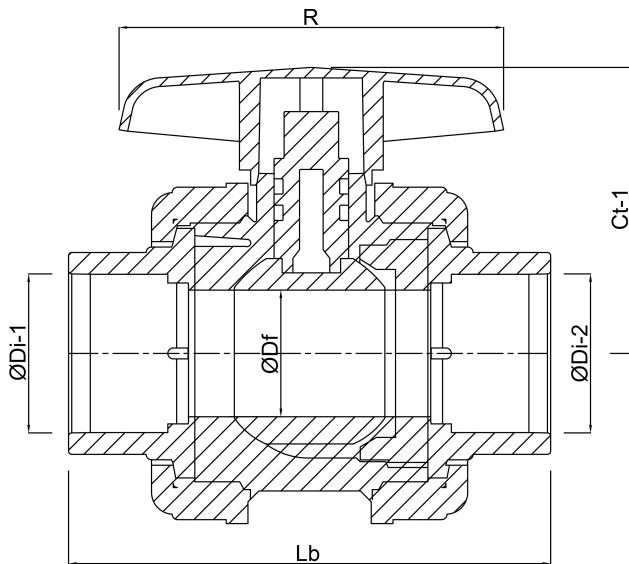

Last modified date: 24/05/2026

Bosta UK Ltd.
Reflection House
Olding Road
Bury St. Edmunds
Suffolk
IP33 3TA
T +44 (0) 1284 716580
E enquiries@bosta.co.uk
<http://www.bosta.com>