

Profec Ball valve PP/PE 63 mm butt welding 10bar DN50 (7036198)



TECHNICAL SPECIFICATIONS

Material PP/PE

Operation lever

Colour lever blue

Handle material PP

Material housing PP

Material seal EPDM

Connection butt welding

Pressure 10 bar

Size 63 mm

DN 50

DIMENSIONS

Ct-1 105 mm

Lb 300 mm

R 74 mm

ØDf 50 mm

ØDo-1 63 mm

ØDo-2

63 mm

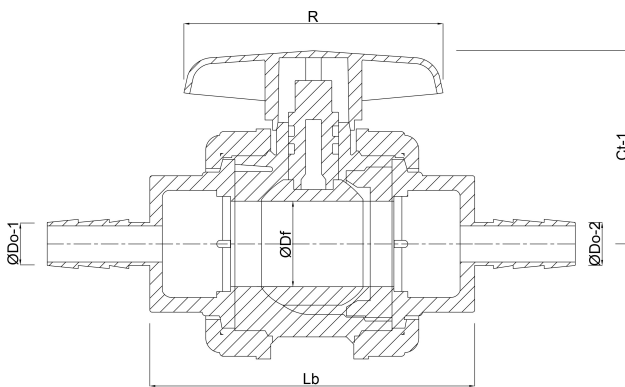

Last modified date: 27/05/2026

Bosta UK Ltd.
Reflection House
Olding Road
Bury St. Edmunds
Suffolk
IP33 3TA
T +44 (0) 1284 716580
E enquiries@bosta.co.uk
<http://www.bosta.com>