

**Hose tail steel 100 mm x 104  
mm x 2 mm butt welding x  
hose tail black (0200700)**



# TECHNICAL SPECIFICATIONS

Colour	black
Material	steel
Connection	butt welding x hose tail
Wall thickness	2 mm
Size	100 mm x 104 mm

# DIMENSIONS

L	200 mm
Nq-2	2
ØDo-1	100 mm
ØDo-2	104 mm

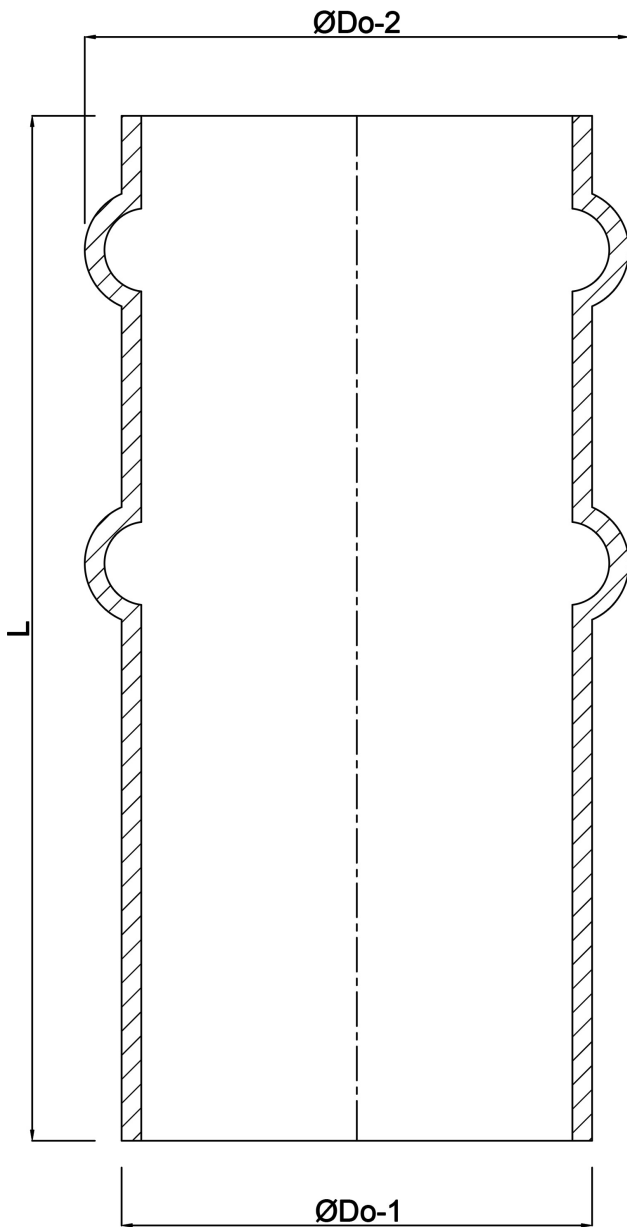

**Last modified date: 25/05/2026**

Bosta UK Ltd.  
Reflection House  
Olding Road  
Bury St. Edmunds  
Suffolk  
IP33 3TA  
T +44 (0) 1284 716580

[E enquiries@bosta.co.uk](mailto:enquiries@bosta.co.uk)

<http://www.bosta.com>