

Profec Ball valve PP/PE 50 mm butt welding 10bar DN40 (7036197)



TECHNICAL SPECIFICATIONS

Material PP/PE

Operation lever

Colour lever blue

Handle material PP

Material housing PP

Material seal EPDM

Connection butt welding

Pressure 10 bar

Size 50 mm

DN 40

DIMENSIONS

Ct-1 92 mm

Lb 263 mm

R 65 mm

ØDf 40 mm

ØDo-1 50 mm

ØDo-2

50 mm

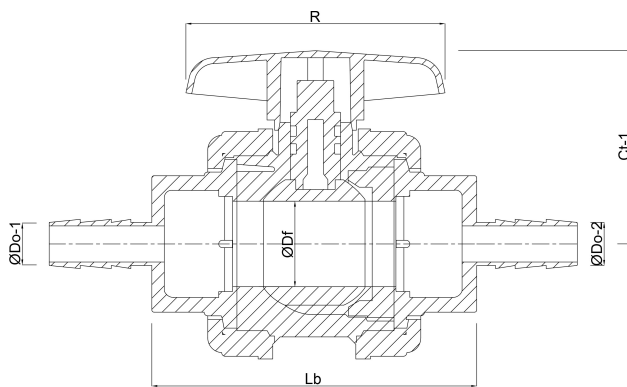

Last modified date: 27/05/2026

Bosta UK Ltd.
Reflection House
Olding Road
Bury St. Edmunds
Suffolk
IP33 3TA
T +44 (0) 1284 716580
E enquiries@bosta.co.uk
<http://www.bosta.com>