

Grundfos Multi-stage centrifugal pump stainless steel 1 1/4" 1A 400VAC type CRI 1S-11 A CA I V HQQV (7039616)



GRUNDFOS 

TECHNICAL SPECIFICATIONS

Material	stainless steel
----------	-----------------

Shaft	stainless steel 316
-------	---------------------

Pump body	stainless steel 316
-----------	---------------------

Material impeller 1	stainless steel 304
---------------------	---------------------

Voltage	400VAC
---------	--------

Temperature range	-20°C - 90°C
-------------------	--------------

Maximum ambient temperature	40 °C
-----------------------------	-------

Minimum ambient temperature	0 °C
-----------------------------	------

Type	CRI 1S-11 A CA I V HQQV
------	-------------------------

Output Power	0.5 HP
--------------	--------

Size	1 1/4"
------	--------

Power	0.37 kW
-------	---------

Impellers	11
-----------	----

MWC	65
-----	----

Ampere	1 A
--------	-----

Max flow rate	1.1 m ³ /h
---------------	-----------------------

Suction	1 1/4 "
---------	---------

Efficiency 73,8 %

Motor RPM 2770

DIMENSIONS

L 162 mm

H-1 592 mm

W-1 210 mm

ØDi-1 35 mm

ØDi-2 35 mm

ØDi-1 1 1/4 "

ØDi-2 1 1/4 "

Cb-1 50 mm

Cb-2 50 mm

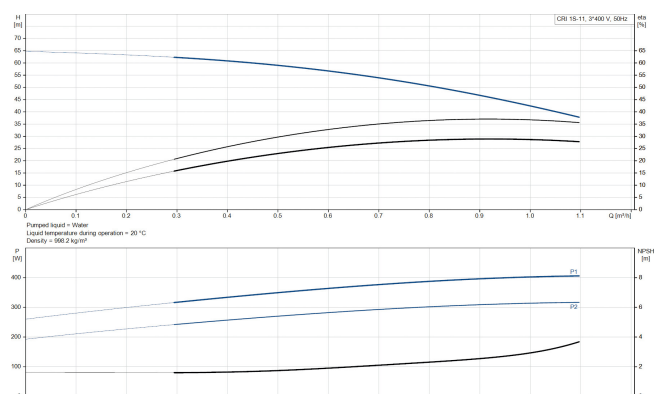
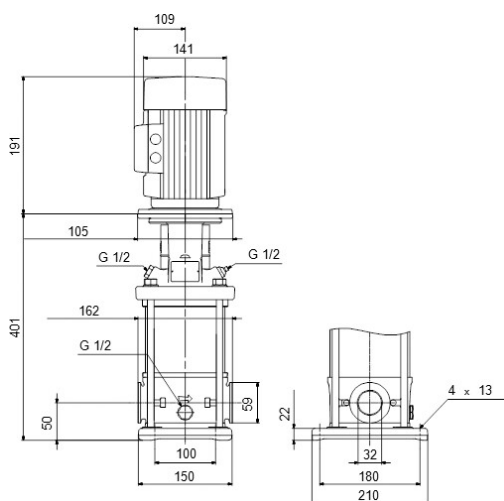

PRODUCT INFORMATION

Grundfos CRI pumps are vertical, non-self-priming, multistage, in-line, centrifugal pumps for installation in pipe systems and mounting on a foundation, suitable for industrial applications. This design provides a more compact pump design and pipework. CR pumps are designed for a variety of applications ranging from the pumping of potable water to the pumping of chemicals. The pumps are therefore suitable for a wide range of pumping systems where the performance and material of the pump meet specific demands.

Last modified date: 12/02/2026

Bosta UK Ltd.
Reflection House
Olding Road
Bury St. Edmunds
Suffolk
IP33 3TA
T +44 (0) 1284 716580
E enquiries@bosta.co.uk
<http://www.bosta.com>