

**Hose tail steel 150 mm x 154
mm x 2 mm butt welding x
hose tail black (0200705)**



TECHNICAL SPECIFICATIONS

Colour	black
Material	steel
Connection	butt welding x hose tail
Wall thickness	2 mm
Size	150 mm x 154 mm

DIMENSIONS

L	200 mm
Nq-2	2
ØDo-1	150 mm
ØDo-2	154 mm

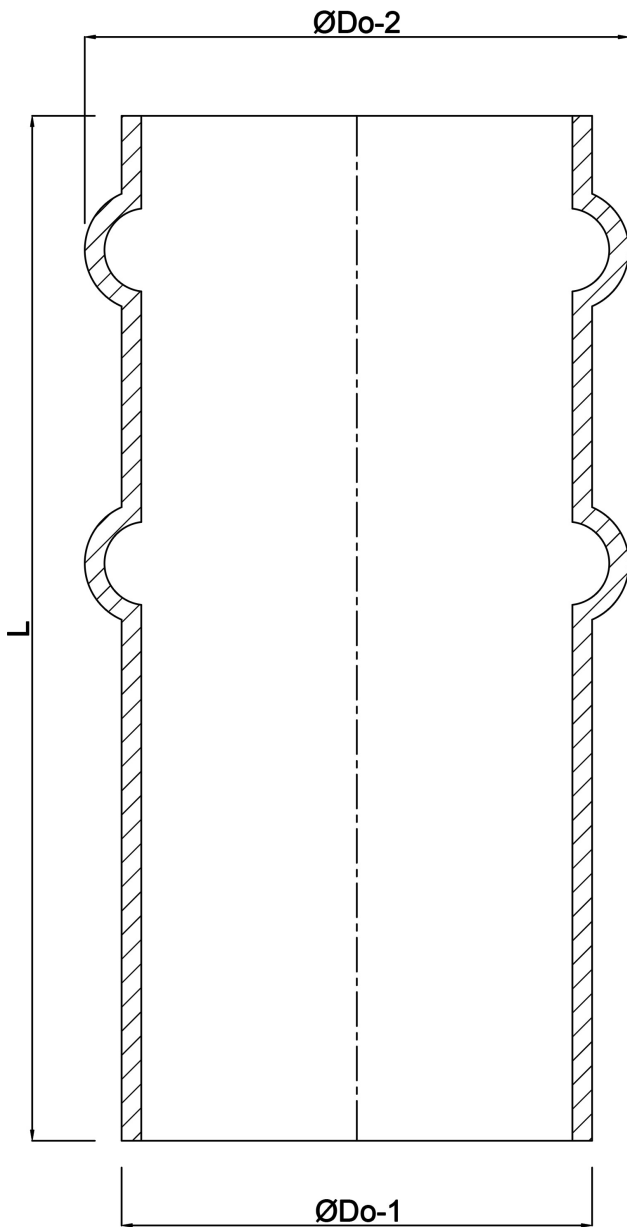

Last modified date: 25/05/2026

Bosta UK Ltd.
Reflection House
Olding Road
Bury St. Edmunds
Suffolk
IP33 3TA
T +44 (0) 1284 716580

[E enquiries@bosta.co.uk](mailto:enquiries@bosta.co.uk)

<http://www.bosta.com>