

**3-way ball valve L-bore PVC-U
25 mm glue socket 10bar DN20
grey type L-bore side
connection (0111642)**



TECHNICAL SPECIFICATIONS

Colour grey

Type L-bore

Material PVC-U

Operation lever

Colour lever red

Handle material PVC-U

Material housing PVC-U

Material seal PTFE/EPDM

Ball bore L-bore

Connection type side connection

Connection glue socket

Temperature range 0°C - 60°C

Pressure 10 bar

Size 25 mm

DN 20

DIMENSIONS

Ct-1 52 mm

Lb 123 mm

R 85 mm

\varnothing Df 20 mm

\varnothing Di-1 25 mm

\varnothing Di-2 25 mm

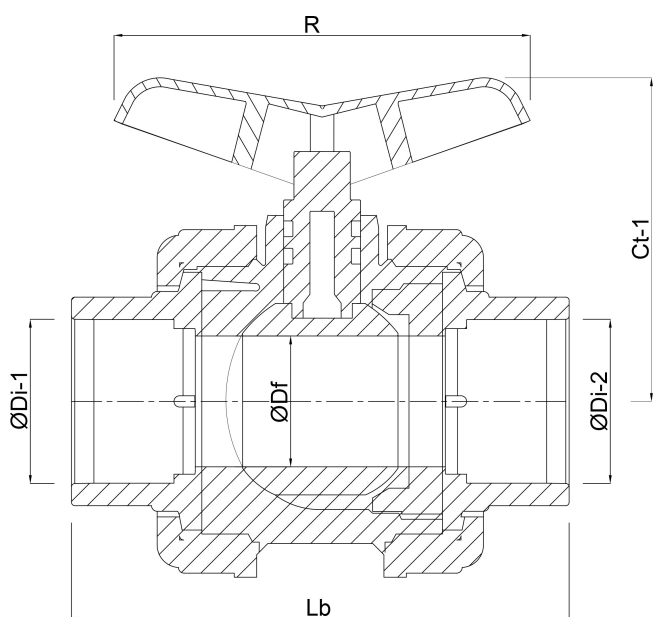

Last modified date: 07/03/2026

Bosta UK Ltd.
Reflection House
Olding Road
Bury St. Edmunds
Suffolk
IP33 3TA
T +44 (0) 1284 716580
E enquiries@bosta.co.uk

<http://www.bosta.com>