

Hayward Pool pump PP GF 50 mm glue socket 3,6A 230VAC black type RS II 30081 0.75HP (7017115)



 **HAYWARD**

TECHNICAL SPECIFICATIONS

Colour	black
Pump body	PP GF
Material impeller 1	noryl
Material seal	stainless steel 304
Connection	glue socket
Max. temperature	35 °C
Width	234 mm
Height	305 mm
Frequency	50 Hz
IP value	IP55
Type	RS II 30081
Capacity	12,5 m ³ /h
Output Power	0,75 HP
Size	50 mm
Length	569 mm
Voltage	230VAC
Weight	12.8 kg

Power 0.55 kW

Ampere 3,6 A

BEP Capacity 13

BEP Head 8

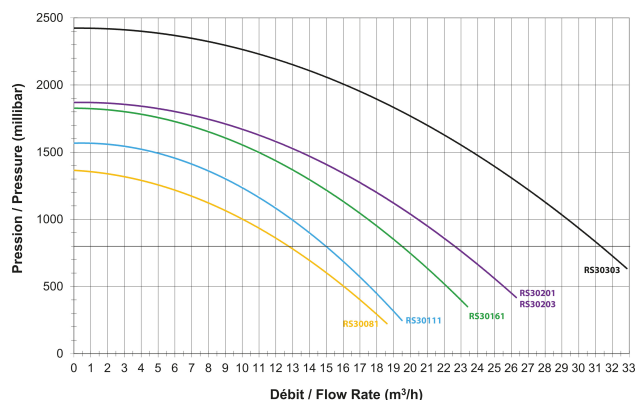
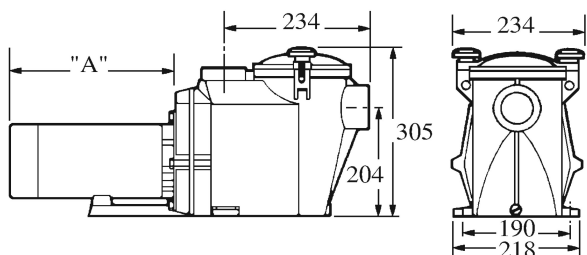

PRODUCT INFORMATION

Quiet, yet heavy-duty, the Hayward RS II pool pump delivers optimum filtration control and less need for cleaning thanks to the spacious filter-basket. The highly-efficient, German motor ensures smooth running and a reliable lifetime.

Features:

- Union connection: Glue socket 63 mm
- Salt water resistant to 0.4% (4gr/ltr)
- Exclusive by Bevo/Bosta
- 180 degrees rotatable box for convenient access
- Suitable for pools up to 100m³

Last modified date: 25/05/2026

Bosta UK Ltd.
Reflection House
Olding Road
Bury St. Edmunds
Suffolk
IP33 3TA
T +44 (0) 1284 716580
E enquiries@bosta.co.uk
<http://www.bosta.com>