

**Grundfos Multi-stage  
centrifugal pump stainless  
steel DN35 DIN flange 2,5A  
400VAC type CRI 1S-30 A FGJ I  
V HQQV (7039627)**

GRUNDFOS 

# TECHNICAL SPECIFICATIONS

Material	stainless steel
----------	-----------------

Shaft	stainless steel 316
-------	---------------------

Pump body	stainless steel 316
-----------	---------------------

Material impeller 1	stainless steel 304
---------------------	---------------------

Connection	DIN flange
------------	------------

Voltage	400VAC
---------	--------

Max. temperature	90 °C
------------------	-------

Minimum medium temperature -20 °C  
(continuous)

Temperature range	-20°C - 90°C
-------------------	--------------

Maximum ambient temperature 40 °C

Minimum ambient temperature	0 °C
-----------------------------	------

Type	CRI 1S-30 A FGJ I V HQQV
------	--------------------------

Output Power	1.5 HP
--------------	--------

Size	DN35
------	------

Power	1.1 kW
-------	--------

Impellers	33
-----------	----

MWC	190
Ampere	2,5 A
Max flow rate	1.1 m <sup>3</sup> /h
Efficiency	82,7 %
Press	35
Motor RPM	2770

## DIMENSIONS

L	250 mm
H-1	1079 mm
W-1	210 mm
ØDi-1	35 mm
ØDi-2	35 mm
Cb-1	75 mm
Cb-2	75 mm

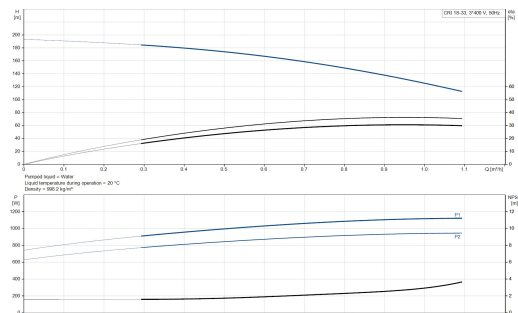
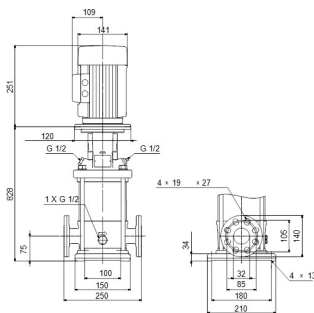

# PRODUCT INFORMATION

Grundfos CRI pumps are vertical, non-self-priming, multistage, in-line, centrifugal pumps for installation in pipe systems and mounting on a foundation, suitable for industrial applications. This design provides a more compact pump design and pipework. CR pumps are designed for a variety of applications ranging from the pumping of potable water to the pumping of chemicals. The pumps are therefore suitable for a wide range of pumping systems where the performance and material of the pump meet specific demands.

**Last modified date: 07/10/2025**

Bosta UK Ltd.  
Reflection House  
Olding Road  
Bury St. Edmunds  
Suffolk  
IP33 3TA  
T +44 (0) 1284 716580  
E [enquiries@bosta.co.uk](mailto:enquiries@bosta.co.uk)  
<http://www.bosta.com>